

SURVEYOR'S OFFICE

# Hamilton County

*Kenton C. Ward, Surveyor*

*Phone (317) 776-8495*

*Fax (317) 776-9628*

*Suite 188*

*One Hamilton County Square*

*Noblesville, Indiana 46060-2230*

October 22, 2004

TO: Hamilton County Drainage Board

RE: Village of West Clay Drain, Section 9004Arm.

Attached is a petition filed by Brenwick Development along with a non-enforcement request, plans, calculations, quantity summary and assessment roll for the Section 9004 Arm, Village of West Clay Drain to be located in Clay Township. I have reviewed the submittals and petition and have found each to be in proper form.

I have made a personal inspection of the land described in the petition. Upon doing so, I believe that the drain is practicable, will improve the public health, benefit a public highway, and be of public utility and that the costs, damages and expenses of the proposed drain will probably be less than the benefits accruing to the owners of land likely to be benefited. The drain will consist of the following:

12" RCP	341 feet	15" RCP	397 feet
18" RCP	491 feet	21" RCP	343 feet
24" RCP	90 feet	30" RCP	288 feet

The total length of the drain will be 1,950 feet.

The subsurface drains (SSD) under curbs are not to be part of the regulated drain. This is per the agreement between Brenwick Development and the Hamilton County Commissioners on April 26, 1999. (See Commissioners minute book 93, pages 565-566).

I have reviewed the plans and believe the drain will benefit each lot equally. Therefore, I recommend each lot be assessed equally. I also believe that no damages will result to landowners by the construction of this drain. I recommend a maintenance assessment of \$5.00 per acre for common areas and platted lots, \$5.00 per acre for roadways, with a \$120.00 minimum. With this assessment the total annual assessment for this drain/this section will be \$3,043.50.

The petitioner has submitted surety for the proposed drain at this time. Surety shall be submitted prior to the approval of the Hamilton County Board of Commissioners/commencement of construction. The sureties which are in the form of a Performance Bond are as follows:

Agent: Bond Safeguard Insurance  
Date: September 17, 2004  
Number: 5013467  
For: Storm Sewers  
Amount: \$75,772.00

Agent: Bond Safeguard Insurance  
Date: September 17, 2004  
Number: 5013468  
For: Erosion Control  
Amount: \$23,000.00

Parcels assessed for this drain may be assessed for the Collins-Osborn or Williams Creek Drain at sometime in the future. Parcels assessed for this drain will also be assessed for the Elliott Creek Drain.

I believe this proposed drain meets the requirements for Urban Drain Classification as set out in IC 36-9-27-67 to 69. Therefore, this drain shall be designated as an Urban Drain.

I recommend that upon approval of the above proposed drain that the Board also approve the attached non-enforcement request. The request is for the reduction of the regulated drain easement to those easement widths as shown on the secondary plat for Village of West Clay Section 9004 as recorded in the office of the Hamilton County Recorder.

I recommend the Board set a hearing for this proposed drain for November 22, 2004.

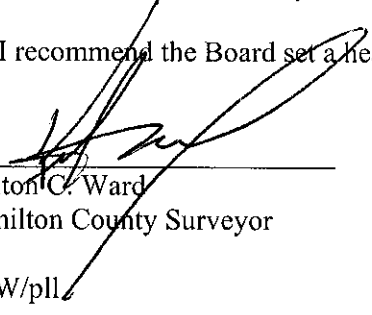

\_\_\_\_\_  
Kenton C. Ward  
Hamilton County Surveyor

KCW/pll

STATE OF INDIANA )  
 )  
COUNTY OF HAMILTON )

TO: HAMILTON COUNTY DRAINAGE BOARD  
% Hamilton County Surveyor  
One Hamilton County Square, Suite 188  
Noblesville, IN. 46060-2230

In the matter of Village of WestClay Subdivision, Section  
9004 Drain Petition.

Petitioner is the owner of all lots in the land affected by the proposed new regulated drain. The drainage will affect various lots in Village of WestClay, a subdivision in Hamilton County, Indiana. The general route of such drainage shall be in existing easements and along public roads as shown in the plans on file in the Surveyor's Office.

Petitioner believes that the cost, damages and expenses of the proposed improvement will be less than the benefits which will result to the owners of the land likely to be benefited thereby. Petitioner believes the proposed improvements will:

- (a) improve public health
- (b) benefit a public street
- (c) be of public utility

Petitioner agrees to pay the cost of construction of the drainage system and requests periodic maintenance assessments by the Board thereafter.

The Petitioner also agrees to the following:

1. To provide the Drainage Board a Performance Bond or Non-Revocable Letter of Credit for the portion of the drainage system which will be made a regulated drain. The bond will be in the amount of 120% of the Engineer's estimate. The bond will be in effect until construction of 100% of the system is completed and so certified by the Engineer.
2. The Petitioner shall retain an Engineer throughout the construction phase. At completion of the project the Petitioner's Engineer shall certify that the drainage system which is to be maintained as a regulated drain has been constructed as per construction plans.
3. The Petitioner agrees to request in writing to the County Surveyor any changes from the approved plan and must receive written authorization from the County Surveyor prior to implementation of the change. All changes shall be documented and given to the Surveyor to be placed in the Drain file.
4. The Petitioner shall instruct his Engineer to provide a reproducible print on a 24" x 36" Mylar of the final design of the Drainage System. This shall be submitted to the County Surveyor prior to the release of the Performance Bond.
5. The Petitioner shall comply with the Erosion Control Plan as specified on the construction plans. Failure to comply with the Erosion Control Plan shall be determined by the Board as being an obstruction to the drainage system. The County Surveyor shall immediately install or repair the needed measures at Petitioners cost as per IC 36-9-27-46.

FILED

SEP 03 2004

The Petitioner further requests that the Drain be classified as an Urban Drain as per IC 36-9-27-69(d).

**RECORDED OWNER(S) OF LAND INVOLVED**

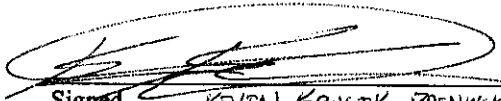

Signed KEVIN KRULIK, BREWICK DEVELOPMENT COMPANY INC Signed

AN AGENT TO: BREWICK TND COMMUNITIES, LLC  
Printed Name (OWNER)

Printed Name

9/2/04  
Date

Date

Signed

Signed

Printed Name

Printed Name

Date

Date



DATE: August 6, 2004

CUSTOMER: Brenwick Development Co.

JOB NAME: West Clay 9004

LOCATION: Carmel, IN

**VALENTI-HELD CONTRACTOR / DEVELOPER, INC.** agrees to furnish and install the necessary materials, equipment, and labor, in the manner described below, and to perform such construction in a workmanlike manner, and as expeditiously as the construction schedule and weather conditions permit (but subject to delays from causes beyond our control; such as strikes, shortage of labor, fires, accidents, or acts of God). Our workmanship and material is guaranteed for one year from the date of job completion. In the event that defective workmanship or materials are determined to have occurred, **VALENTI-HELD CONTRACTOR / DEVELOPER, INC.** shall be liable only for the replacement of same. This proposal is valid for 30 days & is subject to increase due to fluctuation in labor and material costs if not started within 60 days.

This proposal is based on drawings and specifications prepared by The Schneider Corp dated 7/02/04 with no revisions. All topographic information provided on these drawings is assumed to be within + or - 0.5 feet of the actual elevation encountered at the project site and the average elevation of the entire site is assumed to be within + or - 0.1 feet of the actual elevations that exist on the site. We reserve the right to adjust our earthwork bid amount if a greater variance is found to exist and/or make field adjustments to design elevations (with the engineer's approval) in order to achieve the anticipated earthwork balance. Verification of existing elevations will take place as soon as construction staking for the project occurs.

317-769-6922

1-800-880-0922

FAX 317-769-5525

4937 Fieldstone Drive

Whitestown, IN 46075

FILED

SEP 21 2004

OFFICE OF HAMILTON COUNTY SURVEYOR

West Clay 9004 Proposal & Contract  
08/06/2004

~~... of a deep well dewatering system... below the pipe  
grade.~~

~~K. Sales tax~~

**STORM SEWERS**

**Includes:**

- A. Excavation and placement of the R.C.P. as shown on the drawings.
- B. Inlets and manholes.
- C. Concrete end sections.
- D. Riprap.
- E. Sand backfill as required in proposed pavement areas.
- F. 6" HDPE subsurface drains (double wall) under curbs with lot laterals.
- G. #8 stone backfill as required for subsurface drains.
- H. 3 Year - 70% Maintenance bond.

**Excludes:**

- A. Field engineering and soils testing.
- B. Permits or performance bonds.
- C. Relocation of existing utilities.
- D. Granular or stone bedding of any kind.
- E. #8 stone backfill as required for subsurface drains.
- F. Cost for design engineer to produce as-built record drawings.
- G. Locating or height adjustment of castings due to grade changes made by others (i.e., at the end of the maintenance bond period). This work will be performed on a Time & Material basis.
- H. Sales tax.

**TOTAL BID AMOUNT = \$ 103,853.00**

**WATER MAINS**

**Includes:**

- A. Excavation and placement of the 6" and 8" ductile iron pipe class 350 for water main extended from the existing water main into the proposed project as shown.
- B. 1" copper service laterals (lengths as shown).
- C. Wet taps of the existing water main for service laterals.
- D. Fire hydrants and fittings.
- E. Connections to existing water main.



**BOND SAFEGUARD INSURANCE COMPANY  
Lombard, IL 60148**

HCD B-2004-00074

**SUBDIVISION PERFORMANCE BOND**

**BOND #5013468**

**KNOW ALL MEN BY THESE PRESENTS**, That we, Brenwick Development Company, Inc., 12821 E. New Market Street, Suite 200, Carmel, IN 46032, as Principal, and Bond Safeguard Insurance Company, 1919 S. Highland Avenue, Bldg. A-Suite 300, Lombard, IL 60148, as Surety, are held and firmly bound unto the Board of Commissioners of Hamilton County, One Hamilton County Square, Noblesville, IN 46060, as Owner, in the sum of **\*\*Twenty Three Thousand and 00/100\*\*Dollars (\$23,000.00)**, for payment of which we firmly bind ourselves, our heirs, executors, administrators, and assigns.

**THE CONDITION OF THIS BOND** is such that if the said Principal shall complete the construction of Erosion Control for the Village of WestClay Subdivision, Section 9004, according to the approved plans and specifications on file with the Board of Commissioners of Hamilton County, then this obligation is null and void, otherwise to remain in full force and effect.

**IN WITNESS WHEREOF**, we have hereunto set our hands and seal this 17th Day of September, 2004.

Brenwick Development Company, Inc.

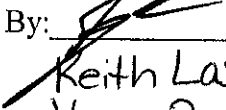
By:   
Keith Lash  
Vice President, Operations

Bond Safeguard Insurance Company

By:   
Deborah M. Roth, Attorney-in-Fact

American Contracting Services, Inc.  
7393 Business Center Drive, Suite 200  
Avon, IN 46123  
(317) 272-4861

POWER OF ATTORNEY  
**Bond Safeguard** INSURANCE COMPANY

AO 31011



KNOW ALL MEN BY THESE PRESENTS, that **BOND SAFEGUARD INSURANCE COMPANY**, an Illinois Corporation with its principal office in Lombard, Illinois, does hereby constitute and appoint:

Anthony George Balzano,

Deborah Mary Roth, Jacqueline Demeter

its true and lawful Attorney(s)-In-Fact to make, execute, seal and deliver for, and on its behalf as surety, any and all bonds, undertakings or other writings obligatory in nature of a bond.

This authority is made under and by the authority of a resolution which was passed by the Board of Directors of **BOND SAFEGUARD INSURANCE COMPANY** on the 7th day of November, 2001 as follows:

Resolved, that the President of the Company is hereby authorized to appoint and empower any representative of the Company or other person or persons as Attorney-In-Fact to execute on behalf of the Company any bonds, undertakings, policies, contracts of indemnity or other writings obligatory in nature of a bond not to exceed \$500,000.00, Five Hundred Thousand Dollars, which the Company might execute through its duly elected officers, and affix the seal of the Company thereto. Any said execution of such documents by an Attorney-In-Fact shall be as binding upon the Company as if they had been duly executed and acknowledged by the regularly elected officers of the Company. Any Attorney-In-Fact, so appointed, may be removed for good cause and the authority so granted may be revoked as specified in the Power of Attorney.

Resolved, that the signature of the President and the seal of the Company may be affixed by facsimile on any power of attorney granted, and the signature of the Vice President, and the seal of the Company may be affixed by facsimile to any certificate of any such power and any such power or certificate bearing such facsimile signature and seal shall be valid and binding on the Company. Any such power so executed and sealed and certificate so executed and sealed shall, with respect to any bond or undertaking to which it is attached, continue to be valid and binding on the Company.

IN WITNESS THEREOF, **BOND SAFEGUARD INSURANCE COMPANY** has caused this instrument to be signed by its President, and its Corporate Seal to be affixed this 7th day of November, 2001.



**BOND SAFEGUARD INSURANCE COMPANY**

BY   
David E. Campbell  
President

**ACKNOWLEDGEMENT**

On this 7th day of November, 2001, before me, personally came David E. Campbell to me known, who being duly sworn, did depose and say that he is the President of **BOND SAFEGUARD INSURANCE COMPANY**, the corporation described in and which executed the above instrument; that he executed said instrument on behalf of the corporation by authority of his office under the By-laws of said corporation.



  
Michele Koller  
Notary Public

**CERTIFICATE**

I, the undersigned, Secretary of **BOND SAFEGUARD INSURANCE COMPANY**, An Illinois Insurance Company, DO HEREBY CERTIFY that the original Power of Attorney of which the foregoing is a true and correct copy, is in full force and effect and has not been revoked and the resolutions as set forth are now in force.

Signed and Sealed at Lombard, Illinois this 17th Day of September, 20 04

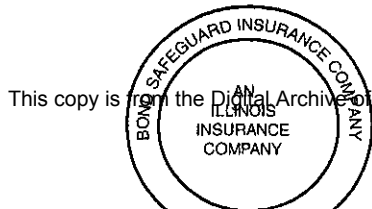

This copy is from the Digital Archives of the Hamilton County Surveyor's Office, Noblesville, IN 46060

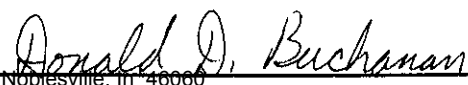
  
Donald D. Buchanan  
Secretary





**BOND SAFEGUARD INSURANCE COMPANY  
Lombard, IL 60148**

HCDB-2004-00073

**SUBDIVISION PERFORMANCE BOND**

**BOND #5013467**

**KNOW ALL MEN BY THESE PRESENTS**, That we, Brenwick Development Company, Inc., 12821 E. New Market Street, Suite 200, Carmel, IN 46032, as Principal, and Bond Safeguard Insurance Company, 1919 S. Highland Avenue, Bldg. A-Suite 300, Lombard, IL 60148, as Surety, are held and firmly bound unto the Board of Commissioners of Hamilton County, One Hamilton County Square, Noblesville, IN 46060, as Owner, in the sum of **\*\*Seventy Five Thousand Seven Hundred Seventy Two and 00/100\*\*Dollars (\$75,772.00)**, for payment of which we firmly bind ourselves, our heirs, executors, administrators, and assigns.

**THE CONDITION OF THIS BOND** is such that if the said Principal shall complete the construction of Storm Sewers for the Village of WestClay Subdivision, Section 9004, according to the approved plans and specifications on file with the Board of Commissioners of Hamilton County, then this obligation is null and void, otherwise to remain in full force and effect.

**IN WITNESS WHEREOF**, we have hereunto set our hands and seal this 17th Day of September, 2004.

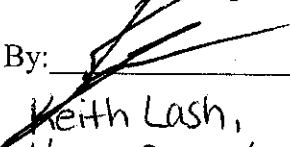
Brenwick Development Company, Inc.  
By:   
Keith Lash,  
Vice President, Operations

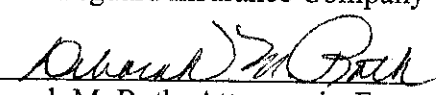
Bond Safeguard Insurance Company  
By:   
Deborah M. Roth, Attorney-in-Fact

American Contracting Services, Inc.  
7393 Business Center Drive, Suite 200  
Avon, IN 46123  
(317) 272-4861



POWER OF ATTORNEY  
**Bond Safeguard** INSURANCE COMPANY

AO 31010

KNOW ALL MEN BY THESE PRESENTS, that **BOND SAFEGUARD INSURANCE COMPANY**, an Illinois Corporation with its principal office in Lombard, Illinois, does hereby constitute and appoint:

Anthony George Balzano,

Deborah Mary Roth, Jacqueline Demeter

its true and lawful Attorney(s)-In-Fact to make, execute, seal and deliver for, and on its behalf as surety, any and all bonds, undertakings or other writings obligatory in nature of a bond.

This authority is made under and by the authority of a resolution which was passed by the Board of Directors of **BOND SAFEGUARD INSURANCE COMPANY** on the 7th day of November, 2001 as follows:

Resolved, that the President of the Company is hereby authorized to appoint and empower any representative of the Company or other person or persons as Attorney-In-Fact to execute on behalf of the Company any bonds, undertakings, policies, contracts of indemnity or other writings obligatory in nature of a bond not to exceed \$500,000.00, Five Hundred Thousand Dollars, which the Company might execute through its duly elected officers, and affix the seal of the Company thereto. Any said execution of such documents by an Attorney-In-Fact shall be as binding upon the Company as if they had been duly executed and acknowledged by the regularly elected officers of the Company. Any Attorney-In-Fact, so appointed, may be removed for good cause and the authority so granted may be revoked as specified in the Power of Attorney.

Resolved, that the signature of the President and the seal of the Company may be affixed by facsimile on any power of attorney granted, and the signature of the Vice President, and the seal of the Company may be affixed by facsimile to any certificate of any such power and any such power or certificate bearing such facsimile signature and seal shall be valid and binding on the Company. Any such power so executed and sealed and certificate so executed and sealed shall, with respect to any bond or undertaking to which it is attached, continue to be valid and binding on the Company.

IN WITNESS THEREOF, **BOND SAFEGUARD INSURANCE COMPANY** has caused this instrument to be signed by its President, and its Corporate Seal to be affixed this 7th day of November, 2001.

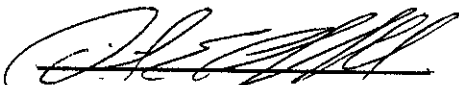

**BOND SAFEGUARD INSURANCE COMPANY**

BY   
David E. Campbell  
President

**ACKNOWLEDGEMENT**

On this 7th day of November, 2001, before me, personally came David E. Campbell to me known, who being duly sworn, did depose and say that he is the President of **BOND SAFEGUARD INSURANCE COMPANY**, the corporation described in and which executed the above instrument; that he executed said instrument on behalf of the corporation by authority of his office under the By-laws of said corporation.

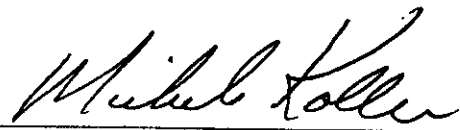

  
Michele Koller  
Notary Public

**CERTIFICATE**

I, the undersigned, Secretary of **BOND SAFEGUARD INSURANCE COMPANY**, An Illinois Insurance Company, DO HEREBY CERTIFY that the original Power of Attorney of which the foregoing is a true and correct copy, is in full force and effect and has not been revoked and the resolutions as set forth are now in force.

Signed and Sealed at Lombard, Illinois this 17th Day of September, 2004

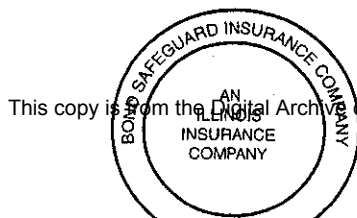

This copy is from the Digital Archive of the Hamilton County Surveyor's Office, Noblesville, IN 46060

  
Donald D. Buchanan  
Secretary

FINDINGS AND ORDER

CONCERNING THE MAINTENANCE OF THE

Village of West Clay Drain, Section 9004 Arm

On this **22nd day of November, 2004**, the Hamilton County Drainage Board has held a hearing on the Maintenance Report and Schedule of Assessments of the **Village of West Clay Drain, Section 9004 Arm**.

Evidence has been heard. Objections were presented and considered. The Board then adopted the original/amended Schedule of Assessments. The Board now finds that the annual maintenance assessment will be less than the benefits to the landowners and issues this order declaring that this Maintenance Fund be established.

HAMILTON COUNTY DRAINAGE BOARD



\_\_\_\_\_  
President

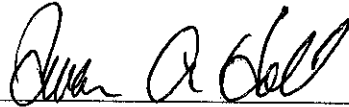

\_\_\_\_\_  
Member

\_\_\_\_\_  
Member

Attest:



CERTIFICATE OF COMPLETION AND COMPLIANCE

TO: HAMILTON COUNTY SURVEYOR  
RE: Village of West Clay Section 9004

I hereby certify that:

1. I am a Register Engineer in the State of Indiana
2. I am familiar with the plans and specifications for the above referenced subdivision.
3. I have personally observed and supervised the completion of the Drainage Facilities for the above referenced subdivision, and
4. To the best of my knowledge, information and belief, the Drainage Facilities within the subdivision has been installed and completed in conformity with all plans and specifications.

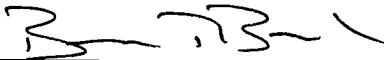
Signature:  Date: 2-9-05

Type or print name: Brandon T Burke, P.E.

Business /Address: The Schneider Corporation  
12821 E. New Market Street, Suite 100, Carmel, IN 46032

Telephone: (317) 569-8112

INDIANA REGISTRATION NUMBER

PE 10000075

SEAL



FILED  
FEB 11 2005  
HAMILTON COUNTY, INDIANA

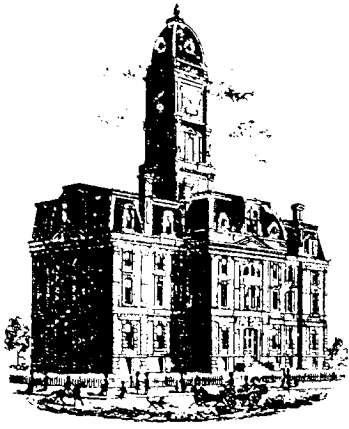

SURVEYOR'S OFFICE

# Hamilton County

*Kenton C. Ward, CFM*  
*Surveyor of Hamilton County*  
*Phone (317) 776-8495*  
*Fax (317) 776-9628*

*Suite 188*  
*One Hamilton County Square*  
*Noblesville, Indiana 46060-2230*

**To: Hamilton County Drainage Board**

**March 21, 2007**

**Re: Village West Clay: Section 9004**

Attached are as-builts, certificate of completion & compliance, and other information for Villages of West Clay Section 9004. An inspection of the drainage facilities for this section has been made and the facilities were found to be complete and acceptable.

During construction, changes were made to the drain, which will alter the plans submitted with my report for this drain-dated October 22, 2004. The report was approved by the Board at the hearing held November 22, 2004. (See Drainage Board Minutes Book 8, Pages 67-69)  
 The changes are as follows:

Structure:	Length:	Size	Material:	Up Invert:	Dn Invert	Grade:	Changes(ft):
678-669	53	12	RCP	898.2	895.39	0.85	-2
669-668	29	12	RCP	894.84	894.74	0.34	
668-667	143	15	RCP	894.74	894.61	0.09	1
667-666	136	18	RCP	894.61	894.33	0.21	1
666-665	175	18	RCP	894.33	894.05	0.16	-1
665-664	180	18	RCP	894.05	893.53	0.29	
664-663	29	21	RCP	893.53	893.42	0.38	
663-662	162	21	RCP	893.42	893.07	0.22	1
662-661	152	21	RCP	893.07	892.9	0.11	-1
661-660	99	24	RCP	892.9	892.8	0.1	9
676-675	29	12	RCP	899.55	895.6	0.86	
675-660	196	15	RCP	895.35	892.8	1.3	-7
677-668	53	15	RCP	896.67	895.07	0.62	1
660-656	290	30	RCP	892.8	892.44	0.12	2
684-683	29	12	RCP	897.01	896.8	0.72	
683-682	59	12	RCP	896.8	896.69	0.19	
682-681	43	12	RCP	896.69	896.45	0.56	1
681-680	65	12	RCP	896.45	892.53	6.03	-18

**RCP Pipe Totals:**

12	307
15	392

<b>Other Drain:</b>	
10" HI-Q	677

18	491
21	343
24	99
30	290

**Total:** 677

**Total:** 1922

Note: SSD was installed in the rear of lots 51-52 and Block A. This was to correct a drainage problem found in the field and will become a part of the regulated drain. This is listed above as the 10" HI-Q pipe. The length of the drain due to the changes described above is now **2,599 feet**.

The non-enforcement was approved by the Board at its meeting on November 22, 2004 and recorded under instrument #200500005502.

The following sureties were guaranteed by Bond Safeguard Insurance Company and have expired.

**Bond-LC No:** 5013467  
**Insured For:** Storm Sewers  
**Amount:** \$75,772.00  
**Issue Date:** September 17, 2004

**Bond-LC No:** 5013468  
**Insured For:** Erosion Control  
**Amount:** \$23,000.00  
**Issue Date:** September 17, 2004

I recommend the Board approve the drain's construction as complete and acceptable.

Sincerely,

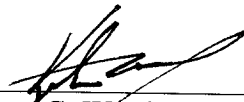
  
 \_\_\_\_\_  
 Kenton C. Ward, CFM  
 Hamilton County Surveyor

KCW/slm

SEC. 28-T18N-R3E

# VILLAGE OF WESTCLAY SECTION 9004

(CONSTRUCTION PLANS)

## HAMILTON COUNTY CARMEL, INDIANA

**SUB-SURFACE DRAINAGE  
 SANITARY SEWER  
 STORM SEWER  
 WATER LINE  
 RECORD DRAWING**

**DEVELOPER:**

**BRENWICK DEVELOPMENT CO.**

12821 E. NEW MARKET STREET, SUITE 200

CARMEL, INDIANA 46032

(317) 574-3400

(317) 574-3919 FAX

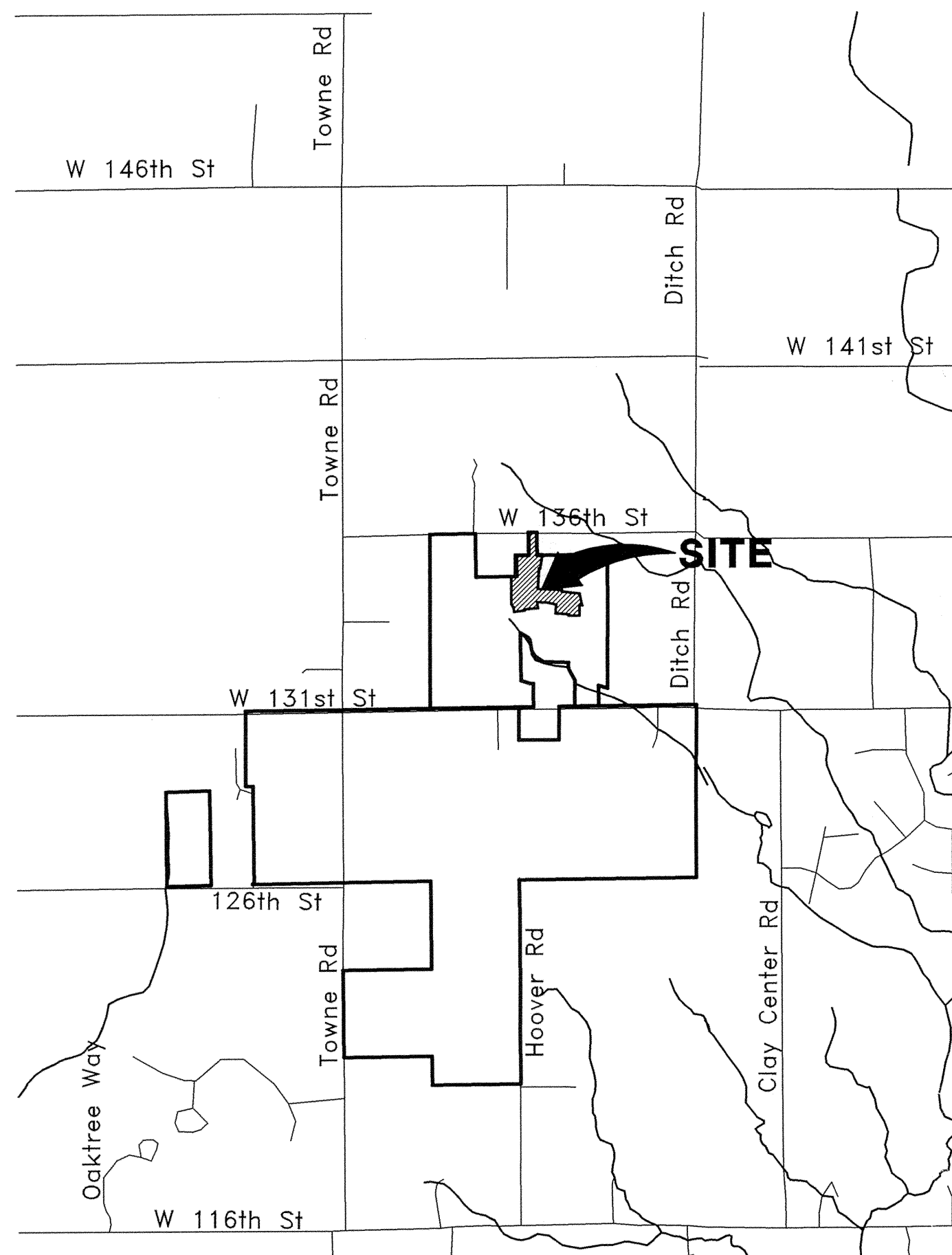

**AREA MAP**  
NOT TO SCALE

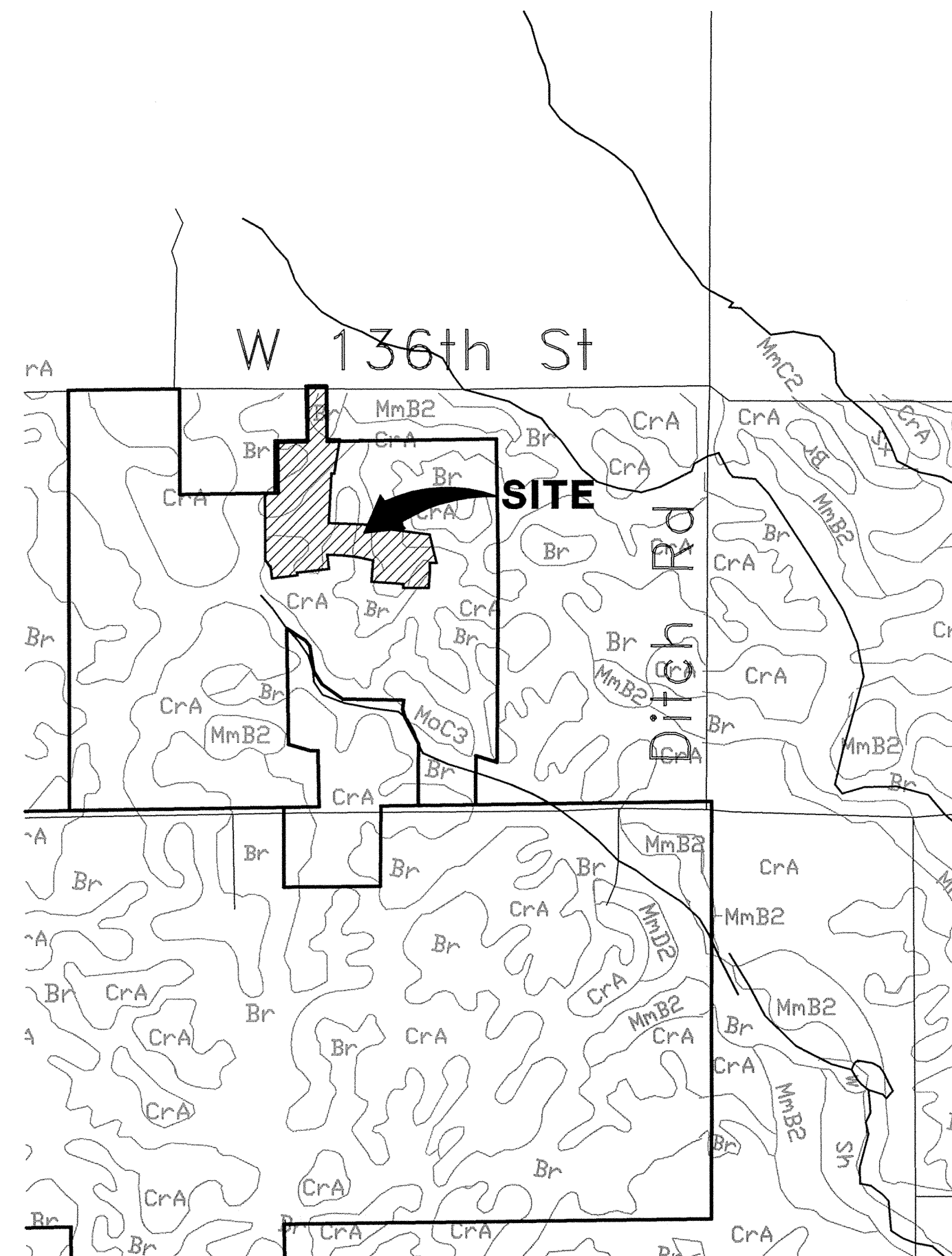

**SOILS MAP**  
NOT TO SCALE

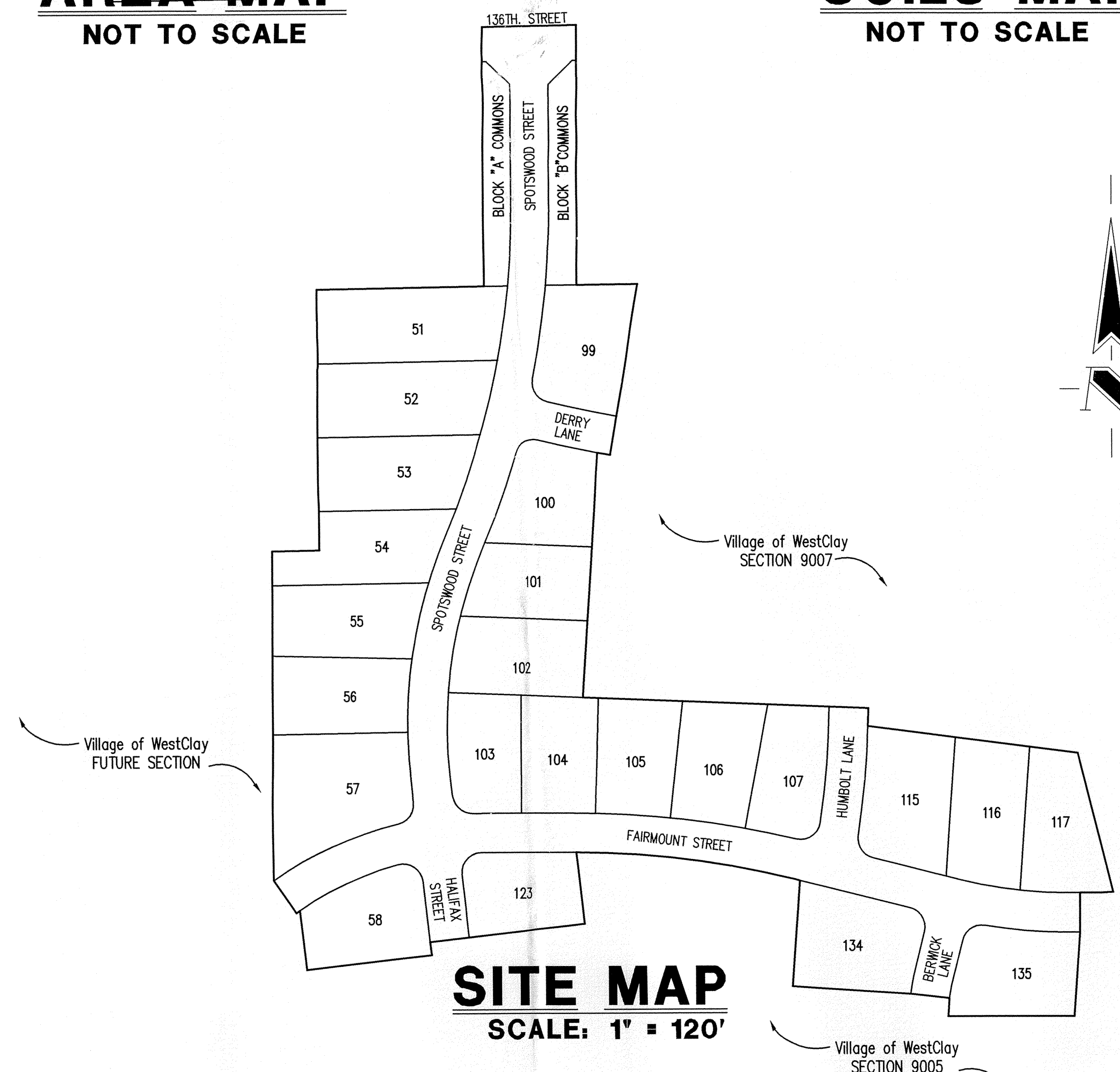

**SITE MAP**  
SCALE: 1" = 120'

**ROADWAY DESIGN  
 SPEED = 20MPH**

INDEX	
SHEET No.	DESCRIPTION
C100	COVER SHEET
C101	DEVELOPMENT PLAN
C102	STORMWATER POLLUTION PREVENTION PLAN
C103	TRAFFIC CONTROL PLAN
C201-C203	STREET PLAN & PROFILE
C301	ENTRANCE PLAN
C302	TRAFFIC OF MAINTENANCE PLAN
C303	INTERSECTION DETAILS
C401-C402	SANITARY SEWER PLAN & PROFILE
C601-C602	STORM SEWER PLAN & PROFILE
C701	WATER DISTRIBUTION PLAN
C702	WATER DETAILS AND SPECIFICATIONS
C801	GENERAL DETAILS
C802-C803	STORMWATER POLLUTION PREVENTION DETAILS & SPECIFICATIONS
C804	HAMILTON COUNTY DETAILS
C901	SPECIFICATIONS
L101	LANDSCAPE PLAN

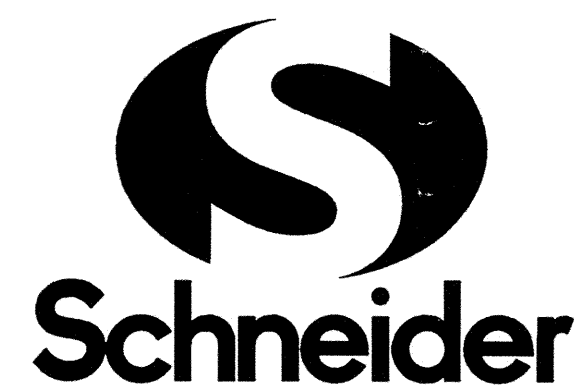

12821 E. New Market Street  
 Suite 100  
 Carmel, IN 46032  
 Telephone: 317.569.8112  
 Fax: 317.826.6410  
 www.schneidercorp.com

Architecture  
 Civil Engineering  
 Environmental Engineering  
 Geotechnical Services  
 GIS \* LIS  
 Home Builder Services  
 Interior Design  
 Land Surveying  
 Landscape Architecture  
 Transportation Engineering

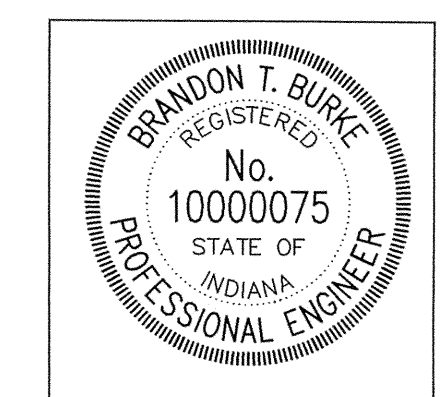
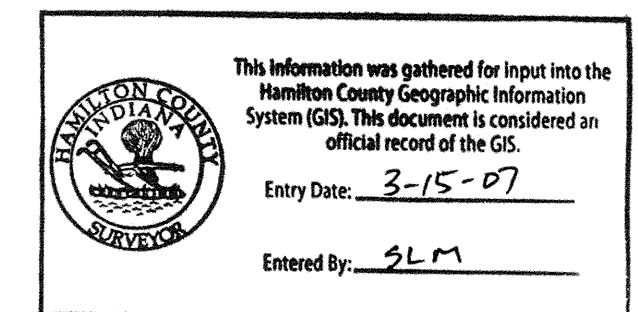

CERTIFIED BY: BRANDON T. BURKE  
 E-MAIL ADDRESS: bburke@schneidercorp.com

DATE: 7/02/04

REVISIONS:		
DATE:	BY:	DESCRIPTION:
8/18/04	BET	ALL SHEETS
9/15/04	BET	C101 & C602
10/19/04	J.F.	C101, C102, C301, C601
1/13/05	BET	"RECORD DRAWING"

PROJECT ENGINEER: \_\_\_\_\_  
 CHECKED BY: \_\_\_\_\_ DATE CHECKED: \_\_\_\_\_

© 2004, The Schneider Corporation

JOB No. 1238.9004

SHEET  
**C100**  
 OF  
 22

# SUB-SURFACE DRAINAGE SANITARY SEWER STORM SEWER RECORD DRAWING

FOR CONTINUATION SEE THIS SHEET AT RIGHT

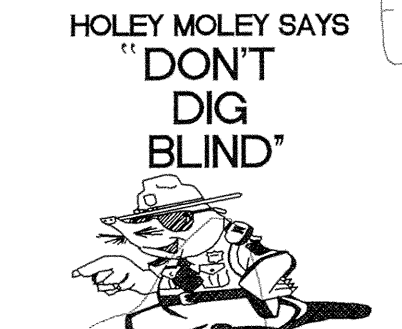

**"IT'S THE LAW"**  
CALL WORKING DAYS BEFORE YOUR WORK  
1-800-382-5544  
CALL TOLL FREE  
PER INDIANA STATE LAW IS 69-1891  
IT IS AGAINST THE LAW TO EXCAVATE  
WITHOUT NOTIFYING THE UNDERGROUND  
LOCATION SERVICE TWO (2) WORKING  
DAYS BEFORE COMMENCING WORK  
CONTACT THE CITY OF CARMEL UTILITY  
DEPARTMENT AT (317) 571-2648 FOR  
FIELD LOCATIONS OF CITY WATER MAINS

NOTE:  
STORM SEWER CASTINGS TO BE LABELED  
"DUMP NO WASTE - DRAINS TO WATERWAY"

NOTE:  
NO KNOWN PUBLIC WATER SYSTEMS WITHIN 50' OF  
PROPOSED SANITARY SEWERS.  
NO F.E.M.A. OR D.N.R. MAPPED 100 YEAR  
FLOODWAY OR FLOODPLAIN PER HAMILTON  
COUNTY, IN, MAP NUMBER 18057C02026F.



TYPICAL CATCH BASIN  
(NON-TRAFFIC AREAS ONLY)

ASSUMED NORTH  
SCALE: 1"=50'

## BENCHMARK

TBM #44  
USGS BENCHMARK  
CUT "X" NORTH BONNET BOLT IN FIRE HYDRANT  
EAST SIDE HOOVER RD. ±100' SOUTH OF CLARIDGE  
FARM ENTRANCE.  
ELEVATION - 893.39

## GENERAL NOTES

- ALL GRADES AT BOUNDARY SHALL MEET EXISTING GRADES. IT SHALL BE THE RESPONSIBILITY OF EACH CONTRACTOR TO VERIFY ALL EXISTING UTILITIES AND CONDITIONS PERTAINING TO HIS PHASE OF WORK. IT SHALL ALSO BE THE CONTRACTOR'S RESPONSIBILITY TO CONTACT THE OWNERS OF THE VARIOUS UTILITIES FOR PROPER STAKE LOCATIONS FOR EACH UTILITY BEFORE WORK IS STARTED. THE CONTRACTOR SHALL NOTIFY IN WRITING THE OWNER OR THE ENGINEER OF ANY CHANGES, OMISSIONS, OR ERRORS FOUND ON THESE PLANS OR IN THE FIELD BEFORE WORK IS STARTED OR RESUMED.
- STANDARD SPECIFICATIONS FOR THE HAMILTON COUNTY SURVEYOR SHALL APPLY FOR ALL STORM SEWERS.
- STANDARD SPECIFICATIONS FOR CLAY TOWNSHIP REGIONAL WASTE DISTRICT SHALL APPLY FOR ALL SANITARY SEWERS.
- ANY PART OF THE SANITARY OR STORM SEWER TRENCHES RUNNING UNDER PAVED AREAS TO BE BACKFILLED WITH GRANULAR MATERIAL.
- THE SIZE AND LOCATION OF EXISTING UTILITIES SHOWN ARE PER INFORMATION PROVIDED BY THE RESPECTIVE UTILITY COMPANIES. ALL UTILITY COMPANIES SHOULD BE NOTIFIED PRIOR TO ANY EXCAVATION FOR FIELD LOCATION OF SERVICES.
- SERVICE WALKS SHALL BE NON-REINFORCED CONCRETE 4" THICK AND 4' IN WIDTH.
- 4" CONCRETE SERVICE WALK ACROSS FRONTAGE OF EACH LOT TO BE CONSTRUCTED BY OTHERS.
- EXPANSION JOINTS AREA TO BE PLACED AT ALL WALK INTERSECTIONS AND BETWEEN WALKS AND PLATFORMS. SIDEWALK SCORERS ARE TO BE EQUALLY SPACED BETWEEN EXPANSION JOINTS, CONTRACTION JOINTS AND PERPENDICULAR TO SIDEWALKS AT 5' INTERVALS OR LESS WITH A CONTRACTION JOINT EVERY 20' OR LESS.
- TEMPORARY TRAFFIC CONTROL DURING CONSTRUCTION TO CONFORM TO APPLICABLE LOCAL AND STATE STANDARDS.
- ALL CONSTRUCTION ACTIVITY ON THIS SITE TO BE PERFORMED IN COMPLIANCE WITH APPLICABLE O.S.H.A. STANDARDS FOR WORKER SAFETY.
- CONTRACTOR SHALL MINIMIZE DAMAGE TO EXISTING TREES, REMOVE AND BACKFILL ALL AREAS WHERE ANY FIELD TILE CROSSES PROPOSED HOUSE PADS. ALL FIELD TILES INTERCEPTED TO BE PERPETUATED INTO STORM SEWER SYSTEM OR LAKE. THE SUBCONTRACTOR SHALL NOTIFY IN WRITING THE OWNER AND THE ENGINEER IN ANY CIRCUMSTANCES WHERE THIS CANNOT BE COMPLETED.
- ALL FILL AREAS (ENGINEERED FILL) SHALL BE COMPACTED TO AT LEAST 95 PERCENT OF THE MAXIMUM DRY DENSITY (ASTM D-1557). FILL UNDER THE FOOTING SHALL BE COMPACTED TO AT LEAST 95 PERCENT OF THE MAXIMUM DRY DENSITY (ASTM D-1557). FILL SHOULD EXHIBIT A MAXIMUM DRY DENSITY OF AT LEAST 105 PCF, AND HAVE A LIQUID LIMIT LESS THAN 50 AND PLASTICITY INDEX OF LESS THAN 25. SANDY FILL MUST HAVE LESS THAN 15% FINES PASSING A #200 SIEVE.
- WATERMAIN VALVES SHALL NOT BE LOCATED UNDER PAVEMENT. 100 YEAR FLOODPLAINS, FLOODWAY FRINGS AND FLOODWAYS: NONE

## LEGEND

- Existing Storm Sewer
- New Storm Sewer
- Existing Sanitary Sewer
- New Sanitary Sewer
- Existing Contour
- Existing Elevation
- New Pavement Grade
- All Other Finish Grades
- Match Existing Grades
- Corrected Grades
- Storm Structure Number
- Sanitary Structure Number
- Flow Arrow
- 6" Subsurface Drain
- 4" SSD Lot Lateral
- Swale (S)
- Water Main
- Existing Trees
- Existing Gas Main
- Existing Telephone
- Existing Water Main
- Existing Flowline
- Existing Overhead Utilities
- 2' Chairback curb with gutter
- Minimum Flood Protection Grade
- 2' Above 100 y. Flooding Zone (Lowest Structure Opening Permitted: window, door, etc.)
- Emergency Flood Routing
- Tree Preservation Limits. Delineate w/Orange Construction Fence Prior To Any Earth Moving.
- Minimum Finished Floor Elevation

## Storm Sewer Structure Table

STR. #	T.C.	INV. IN	INV. OUT	DEPTH	STR. SIZE	STR. TYPE	NEENAH CASTING TYPE	PIPE SIZE	DIRECTION
								IN	OUT
E-2056	898.61	892.43	892.43	2.75'	EXISTING		R-1772-A	30"	30"
600	897.80	892.77	892.77	1.67'	60"	MANHOLE	R-4342	24"	30"
601	899.00	894.60	892.88	4.78'	48"	MANHOLE	R-4342	18"	24"
602	898.50	893.12	893.12	3.41'	48"	MANHOLE	R-4342	21"	24"
603	900.63	893.36	893.36	5.29'	48"	MANHOLE	R-3010	21"	21"
604	900.63	893.41	893.41	5.51'	48"	MANHOLE	R-3010	18"	21"
605	897.70	893.73	893.73	2.26'	48"	MANHOLE	R-4342	18"	18"
606	900.30	894.05	894.05	4.50'	48"	MANHOLE	R-1772-A	18"	18"
607	899.80	894.29	894.29	1.07'	24"x24"	STORM STRUCTURE	R-1772-A	15"	18"
608	898.72	894.77	894.61	2.51'	48"	MANHOLE	R-3010	15"	18"
609	898.72	894.61	894.61	2.45'	24"x24"	CURB INLET	R-3010	12"	12"
610	899.50	895.61	895.61	2.45'	24"x24"	CURB INLET	R-3010	12"	12"
611	899.50	895.61	895.75	2.58'	24"x24"	CURB INLET	R-3010	12"	12"
612	898.90	894.73	894.73	0.63'	24"x24"	BEEHIVE INLET	R-4342	12"	SE
613	898.60	895.90	895.90	2.35'	24"x24"	BEEHIVE INLET	R-4342	12"	SE
614	892.30	892.30	892.30	0.00'	END SECTION			12"	NE
615	901.00	895.44	895.44	4.39'	48"	MANHOLE	R-1772-A	12"	12"
616	898.15	893.90	893.90	4.85'	48"	MANHOLE	R-3010	12"	12"
617	900.66	896.77	896.77	2.72'	24"x24"	CURB INLET	R-3010	12"	12"
618	900.66	896.91	896.91	2.58'	24"x24"	CURB INLET	R-3010	12"	12"

\*CONTRACTOR TO VERIFY ABOVE OR ALTERNATE STRUCTURE TYPES AND SIZES PER D-18 ON C801.

REVISIONS:  
1. REVISED PER TAC COMMENTS  
2. REV. 9/15/04, REVISED PER CLIENT - MOVED STR. 678  
3. REV. 10/19/04, REVISED PER CLIENT - MOVED STR. 678  
4. REV. 11/15/04, REVISED PER CLIENT - MOVED STR. 678  
5. REV. 1/15/05, REVISED PER CLIENT - MOVED STR. 678

This information was prepared for the use of the Hamilton County Geographic Information System (GIS). This document is considered an official record of the Hamilton County Corporation.  
Date: 7/02/04  
Drawn By: [Signature]

BRANDON T. BURKE  
REGISTERED  
No. 0000075  
STATE OF INDIANA  
PROFESSIONAL ENGINEER

DATE: 7/02/04  
THIS DRAWING AND THE IDEAS, DESIGNS AND CONCEPTS CONTAINED HEREIN ARE THE EXCLUSIVE INTELLECTUAL PROPERTY OF THE SCHNEIDER CORPORATION AND ARE NOT TO BE USED OR REPRODUCED, IN WHOLE OR IN PART, WITHOUT THE WRITTEN CONSENT OF THE SCHNEIDER CORPORATION.  
© COPYRIGHTED BY THE SCHNEIDER CORP. (2004)

**Schneider**

THE SCHNEIDER CORPORATION  
12821 E. New Market Street  
Suite 100  
Carmel, IN 46032  
Telephone: 317.569.8112  
Fax: 317.826.6410  
www.schneidercorp.com

Architecture  
Civil Engineering  
Environmental Engineering  
Geotechnical Services  
GIS \* LIS  
Home Builder Services  
Interior Design  
Land Surveying  
Landscape Architecture  
Transportation Engineering

Village of WestClay  
SECTION 9004  
CARMEL, INDIANA  
BRENWICK DEVELOPMENT CO.  
CARMEL, INDIANA

DATE: 7/02/04 PROJECT NO.: 1238.9004  
DRAWN BY: BET CHECKED BY:  
SHEET TITLE: DEVELOPMENT PLAN  
DRAWING FILES:  
N:\1238\9004\DWG\C101.DWG  
REF: 9004-BSDWG, 9007-BSDWG  
REF: 9005-BSDWG, 9006-BSDWG  
REF: C101.DWG, C102.DWG  
REF: NR-BS-DWG  
SHEET NO.:  
C101



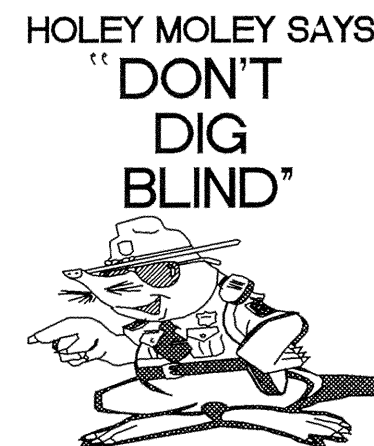

**"IT'S THE LAW"**  
CALL 2 WORKING DAYS BEFORE YOU DIG  
**1-800-382-5544**

CALL TOLL FREE  
PER INDIANA STATE LAW IS-69-1991,  
IT IS AGAINST THE LAW TO EXCAVATE  
WITHOUT NOTIFYING THE UNDERGROUND  
LOCATION SERVICE TWO (2) WORKING  
DAYS BEFORE COMMENCING WORK.

CONTACT THE CITY OF CARMEL UTILITY  
DEPARTMENT AT (317) 571-2648 FOR  
FIELD LOCATIONS OF CITY WATER MAINS.

Sheet	Detail	Description
C801	14	Bedding Detail - Reinforced Concrete Pipe (RCP)
C801	16,18	Curb Inlet Detail
C801	17	Beehive Inlet Detail
C801	15,19	Storm Manhole Detail
C801	12	Precast Concrete End Section
C801	20	Riprap Detail @ End Section

**BENCHMARK**  
TBM #44  
USGS BENCHMARK  
CUT "X" NORTH BONNET BOLT IN FIRE HYDRANT  
EAST SIDE HOOVER RD. ±100' SOUTH OF CLARIDGE  
FARM ENTRANCE.  
ELEVATION - 893.39

- GENERAL NOTES**
- TEMPORARY TRAFFIC CONTROL DURING CONSTRUCTION TO CONFORM TO APPLICABLE LOCAL AND STATE STANDARDS.
  - ALL CONSTRUCTION ACTIVITY ON THIS SITE TO BE PERFORMED IN COMPLIANCE WITH APPLICABLE O.S.H.A. STANDARDS FOR WORKER SAFETY.
  - IT SHALL BE THE CONTRACTORS RESPONSIBILITY TO FIELD VERIFY ALL UTILITY LOCATIONS BEFORE CONSTRUCTION BEGINS.
  - CONTRACTORS SHALL MINIMIZE DAMAGE TO EXISTING TREES.
  - GRANULAR BACKFILL PLACED UNDER PAVED AREAS TO BE COMPACTED IN LIFTS.



**STORM SEWER PLAN**

SCALE: 1"=50'

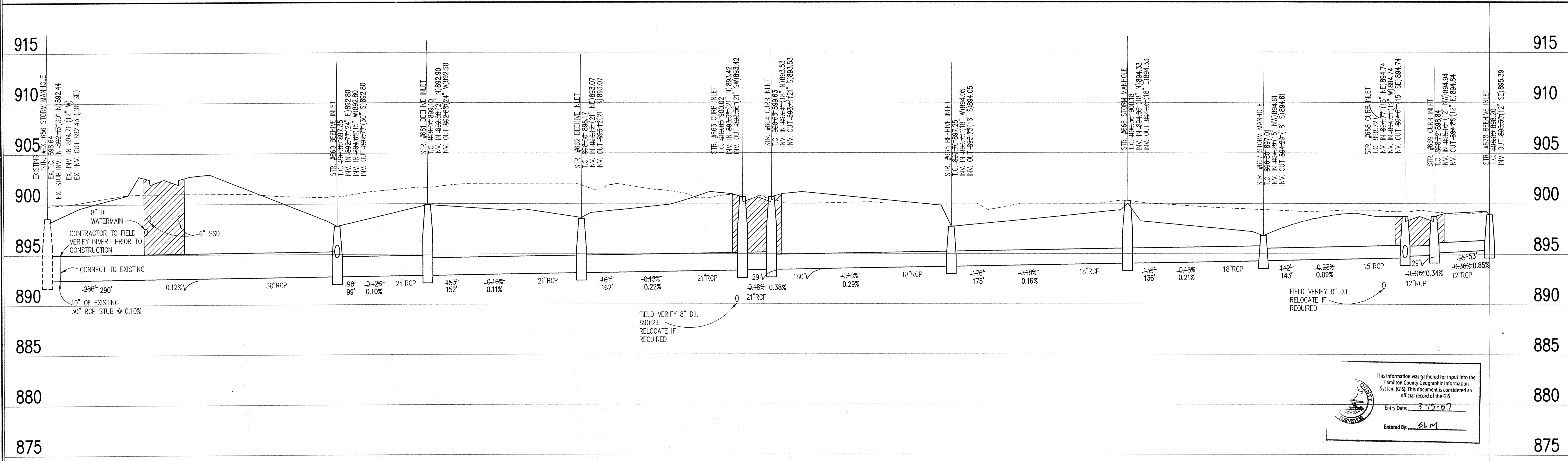

**STORM SEWER RECORD DRAWING**

**STORM SEWER PROFILE**

**LEGEND**

	Existing Grade
	New Grade
	Granular Backfill

SCALE: **HORZ.: 1"=50'**  
**VERT.: 1"=5'**

REVISIONS:  
1. SET 8/18/04, REVISED PER TAG COMMENTS.  
2. SET 10/19/04, REVISED PER CLIENT - MOVED STR 678  
3. SET 1/15/05, RECORD DRAWING

**BRANDON T. BURKE**  
REGISTERED  
No. 0000075  
STATE OF INDIANA  
PROFESSIONAL ENGINEER  
*Brandon T. Burke*  
DATE: 7/02/04  
THIS DRAWING AND THE IDEAS, DESIGNS AND CONCEPTS CONTAINED HEREIN ARE THE EXCLUSIVE INTELLECTUAL PROPERTY OF THE SCHNEIDER CORPORATION AND ARE NOT TO BE USED OR REPRODUCED, IN WHOLE OR IN PART, WITHOUT THE WRITTEN CONSENT OF THE SCHNEIDER CORPORATION.  
© COPYRIGHTED BY THE SCHNEIDER CORP. (2004)

**Schneider**  
THE SCHNEIDER CORPORATION  
12821 E. New Market Street  
Suite 100  
Carmel, IN 46032  
Telephone: 317.569.8112  
Fax: 317.826.6410  
www.schneidercorp.com  
Architecture  
Civil Engineering  
Environmental Engineering  
Geotechnical Services  
GIS \* LIS  
Home Builder Services  
Interior Design  
Land Surveying  
Landscape Architecture  
Transportation Engineering

Village of WestClay  
SECTION 9004  
CARMEL, INDIANA  
BRENWICK DEVELOPMENT CO.  
CARMEL, INDIANA

DATE: 7/02/04 PROJECT NO.: 1238.9004  
DRAWN BY: DCC CHECKED BY:  
SHEET TITLE: STORM SEWER PLAN & PROFILE  
DRAWING FILES:  
N:\1238\9004\DWG\0501-602.DWG  
XREF: 4009-B5.DWG  
XREF: 9006-B5.DWG  
XREF: 9006-B-B5.DWG  
XREF: 9007-B5.DWG  
XREF: 9008-B5.DWG  
XREF: STORM.DWG  
SHEET NO.: C601

N:\1238\9004\dwg\C601-602.dwg, 2/11/2005 12:52:21 PM, bct

**BENCHMARK**

TBM #44  
 USGS BENCHMARK  
 CUT "X" NORTH BONNET BOLT IN FIRE HYDRANT  
 EAST SIDE HOOVER RD. ±100' SOUTH OF CLARIDGE  
 FARM ENTRANCE.  
 ELEVATION - 893.39

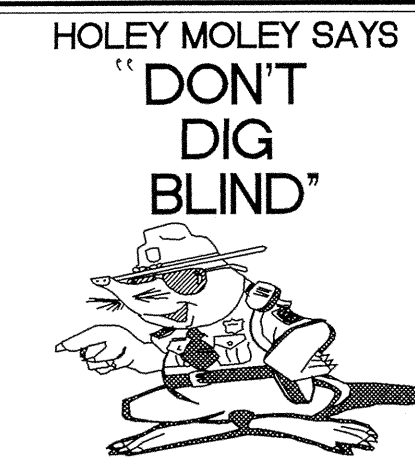

**"IT'S THE LAW"**  
 CALL 2 WORKING DAYS BEFORE YOU DIG  
**1-800-382-5544**  
 CALL TOLL FREE  
 PER INDIANA STATE LAW IS-69-1991.  
 IT IS AGAINST THE LAW TO EXCAVATE  
 WITHOUT NOTIFYING THE UNDERGROUND  
 LOCATION SERVICE TWO (2) WORKING  
 DAYS BEFORE COMMENCING WORK.  
 CONTACT THE CITY OF CARMEL UTILITY  
 DEPARTMENT AT (317) 571-2648 FOR  
 FIELD LOCATIONS OF CITY WATER MAINS.

**GENERAL NOTES**

- TEMPORARY TRAFFIC CONTROL DURING CONSTRUCTION TO CONFORM TO APPLICABLE LOCAL AND STATE STANDARDS.
- ALL CONSTRUCTION ACTIVITY ON THIS SITE TO BE PERFORMED IN COMPLIANCE WITH APPLICABLE O.S.H.A. STANDARDS FOR WORKER SAFETY.
- IT SHALL BE THE CONTRACTORS RESPONSIBILITY TO FIELD VERIFY ALL UTILITY LOCATIONS BEFORE CONSTRUCTION BEGINS.
- CONTRACTORS SHALL MINIMIZE DAMAGE TO EXISTING TREES.
- GRANULAR BACKFILL PLACED UNDER PAVED AREAS TO BE COMPACTED IN LIFTS.

Sheet	Scale	Description
CB01 14		Bedding Detail - Reinforced Concrete Pipe (RCP)
CB01 16,18		Curb Inlet Detail
CB01 17		Beehive Inlet Detail
CB01 15,19		Storm Manhole Detail
CB01 12		Precast Concrete End Section
CB01 20		RipRap Detail @ End Section

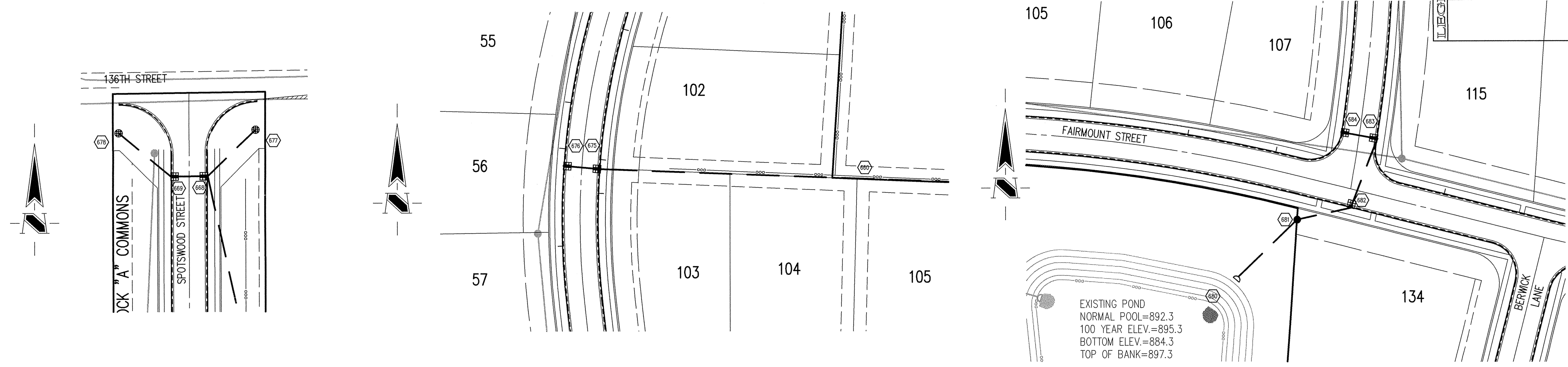

**STORM SEWER PLAN**

SCALE: 1"=50'

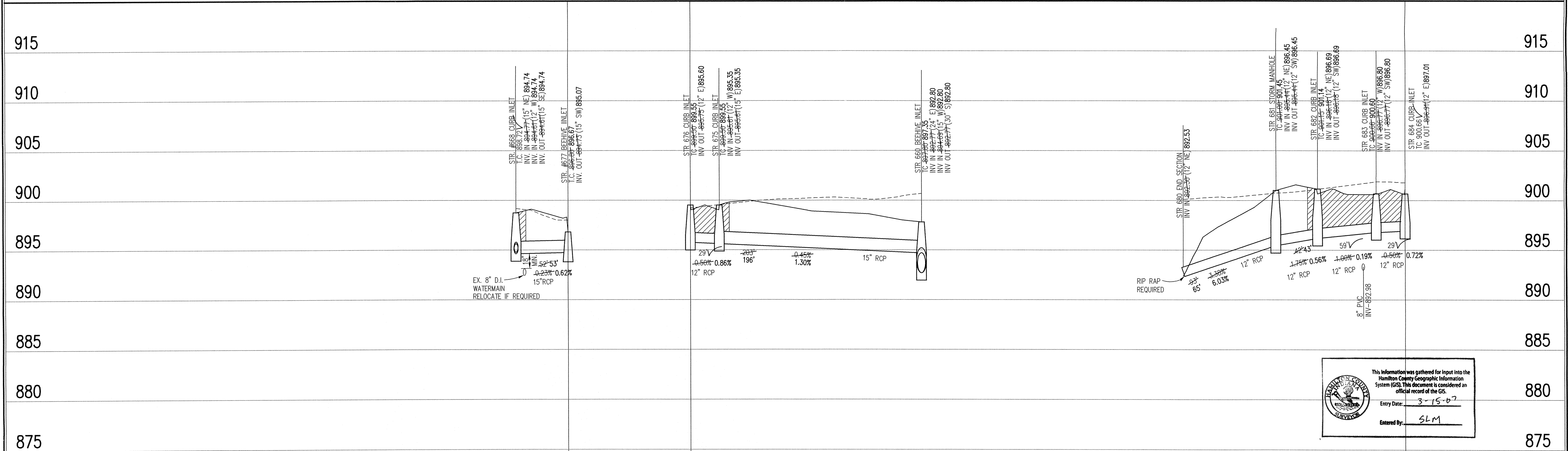

**STORM SEWER RECORD DRAWING**

**STORM SEWER PROFILE**

**LEGEND**

Existing Grade	New Grade	Granular Backfill

SCALE: **HORZ.: 1"=50'**  
**VERT.: 1"=5'**

REVISIONS SHALL BE REVISIONS PER THE COMMENTS.  
 2. BET. 9/15/04, REVISED PER CITY OF CARMEL.  
 3. BET. 1/13/05.

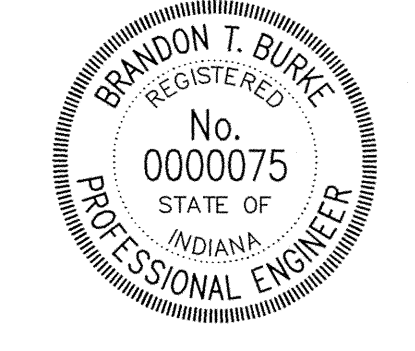

**Brandon T. Burke**  
 DATE: 7/02/04  
 THIS DRAWING AND THE IDEAS, DESIGNS AND CONCEPTS CONTAINED HEREIN ARE THE EXCLUSIVE INTELLECTUAL PROPERTY OF THE SCHNEIDER CORPORATION AND ARE NOT TO BE USED OR REPRODUCED, IN WHOLE OR IN PART, WITHOUT THE WRITTEN CONSENT OF THE SCHNEIDER CORPORATION.  
 © COPYRIGHTED BY THE SCHNEIDER CORP. (2004)



THE SCHNEIDER CORPORATION  
 12821 E. New Market Street  
 Suite 100  
 Carmel, IN 46032  
 Telephone: 317.569.8112  
 Fax: 317.826.6410  
 www.schneidercorp.com

Architecture  
 Civil Engineering  
 Environmental Engineering  
 Geotechnical Services  
 GIS \* LIDAR  
 Home Builder Services  
 Interior Design  
 Land Surveying  
 Landscape Architecture  
 Transportation Engineering

Village of WestClay  
**SECTION 9004**  
 CARMEL, INDIANA  
**BRENNICK DEVELOPMENT CO.**  
 CARMEL, INDIANA

This information was gathered for input into the Hamilton County Geographic Information System (GIS). This document is considered an official record of the GIS.  
 Entry Date: 3-15-07  
 Entered By: SLM

DATE: 7/02/04	PROJECT NO.: 1238.9004
DRAWN BY: DCC	CHECKED BY:
SHEET TITLE: STORM SEWER PLAN & PROFILE	
DRAWING FILES: N:\1238\9004\DWG\0601-602.DWG	
XREF: 9006-B5.DWG	
XREF: 9006-B5.DWG	
XREF: 9006-B5.DWG	
XREF: 9007-B5.DWG	
XREF: 9008-B5.DWG	
XREF: STORM.DWG	
SHEET NO.: C602	